



LANDSCAPE SCREENS & FENCES

Shade Systems Engineered for Comfort and Endurance

METAL
SPACES
A division of Viva Railings, LLC.



VIVA RAILINGS
LEADERS IN ARCHITECTURAL RAILING SYSTEMS



System Overview

 **Engineered sun control and shade systems — sunshades, fins, and free-standing shade structures**





 **CSI Division: 10 10700 – Sun Control Systems**

 **Delivery Model: Turnkey (primary) or supply-only**

A complete line of architectural sun control systems, including fins, louvers, and shade structures, designed to reduce heat gain and enhance occupant comfort. ShadeScapes balances performance, durability, and design flexibility for a wide range of building condition



APPLICATIONS

-  **Exterior Facades:** laser-cut cladding for commercial, hospitality, institutional, and mixed-use projects
-  **Wall Screen Systems:** Parking garages, mechanical wells, rooftop equipment screening
-  **Interior feature walls:** lobbies, atriums, and signature corridors
-  **Storytelling / Branded Environments:** FotoFacade™ for cultural, civic, healthcare, and corporate spaces
-  **Inset / Between-Structure Installs:** Facade screens between floor slabs, steel beams, concrete slabs

KEY FEATURES

- **True Turnkey Delivery:** Single-source design, engineering, fabrication, and optional installation
- **Unlimited Design Expression:** Standard pattern library, custom laser-cut solutions, and FotoFacade™ image-based panels
- **Material & Finish Range:** Aluminum, Stainless Steel, and Steel options with architectural-grade coatings for long-term performance
- **Engineered Mounting Flexibility:** Field-proven attachment to columns, beams, walls, framing, and between floor slabs
- **Proven Performance:** Engineered systems meeting structural and environmental demands



APPLICATION	DIMENSIONS (IN)	PANEL MATERIAL	FINISH
POST	3 W x 3 H	Pregalvanized Steel 1/8" Thk.	Zinc Rich Primer + Powder Coat Mill Finish (paint by others)
IN-LINE PANELS (BETWEEN POSTS)	44 W x 44 H 44 W x 68 H 44 W x 92 H	Aluminum 1/8" Aluminum 3/16" Aluminum 1/4"	Powder Coat (AAMA 2604) \$ ² PVDF (AAMA 2605) ¹ \$\$
SURFACE PANELS	48 W x 44 H 48 W x 68 H 48 W x 92 H	Stainless Steel 14 Ga	Brushed Satin
		Steel 14 Ga Steel 11 Ga	Zinc Rich Primer + Powder Coat Mill Finish (paint by others)

(1) Available as an Upgrade

(2) \$ to \$\$\$: Indicates finish type comparative cost

Finish Options

Powder Coat AAMA-2604

Powder Coat AAMA-2605

Brushed Satin

Powder Coat with zinc rich primer, mill

Material & Properties

Aluminum Alloy: 5052-H32 Series

- 100% Recyclable
- Rust Resistance
- Max Panel Size: 4' x 10"

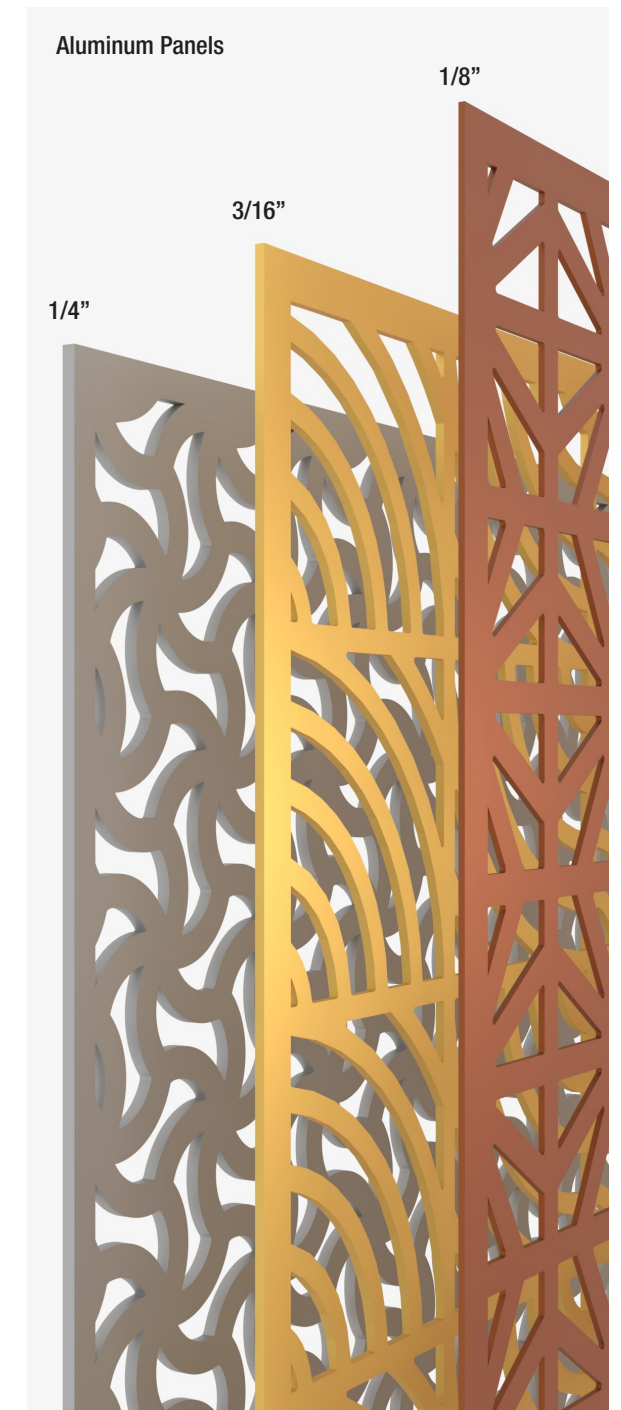

Inline Panels

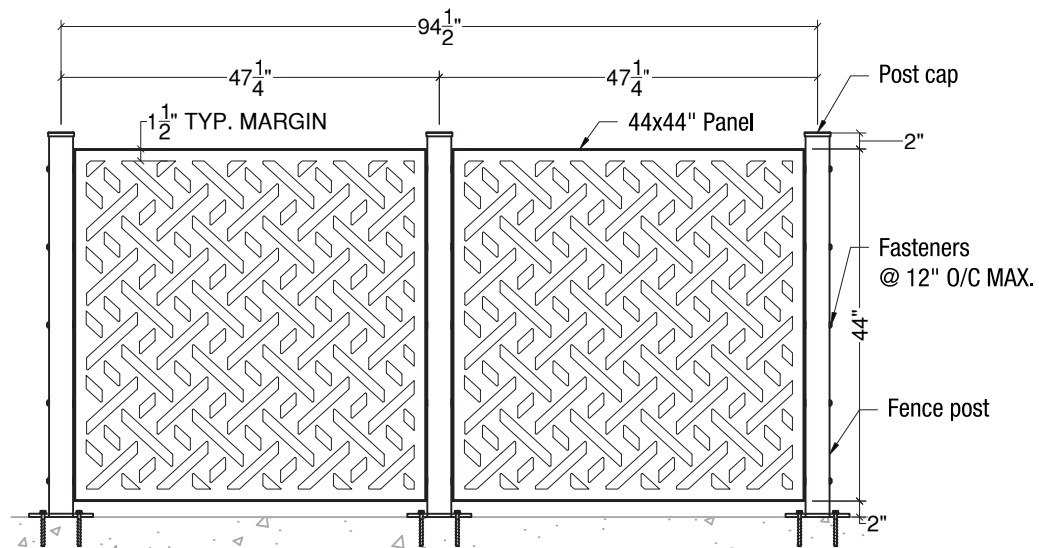

4ft Fence

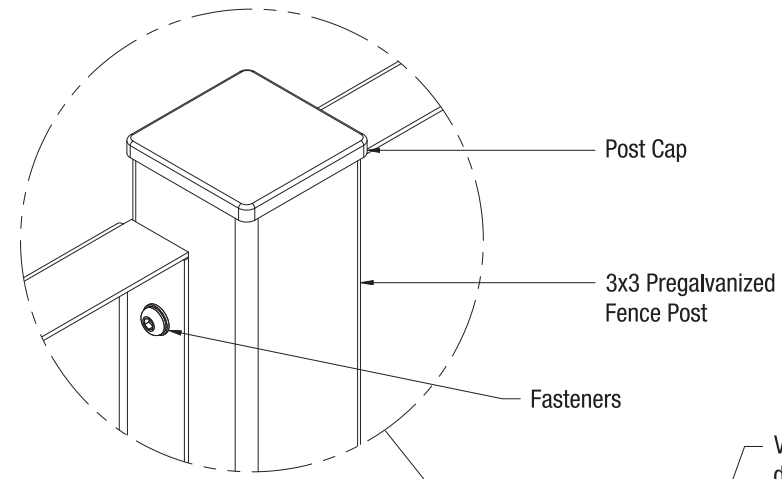

Visit VIVARAILINGS.COM for range of design patterns or provide your custom one.

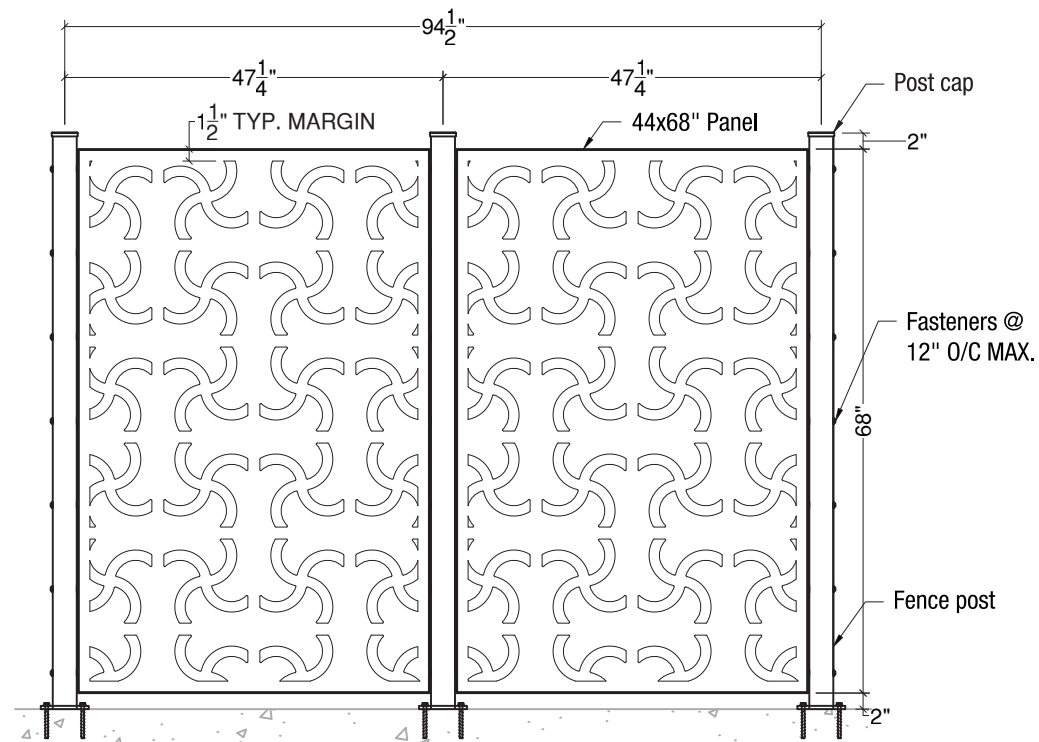

6ft Fence

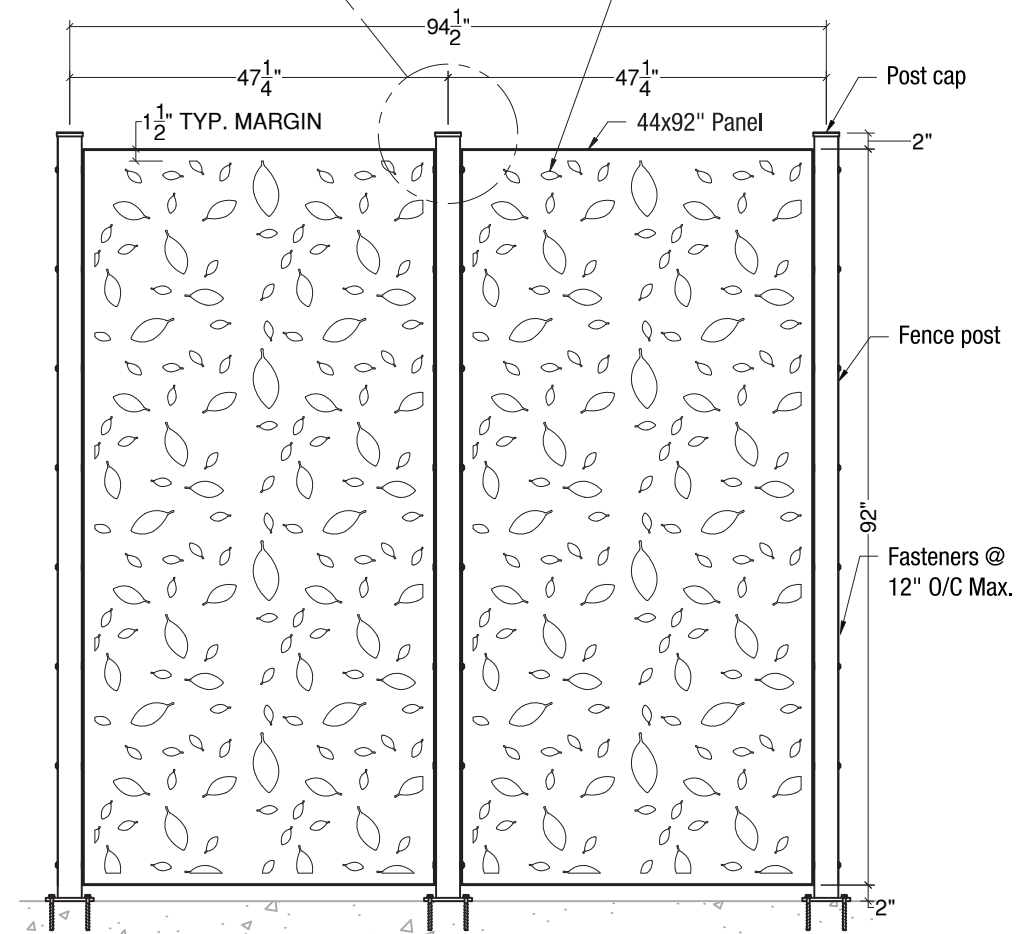

8ft Fence



Surface Panel

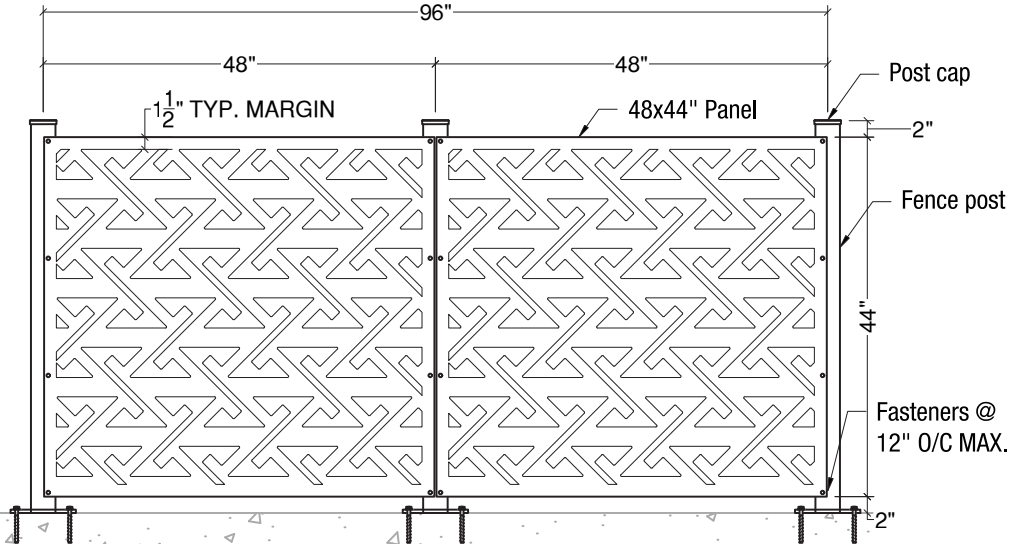

4ft Fence

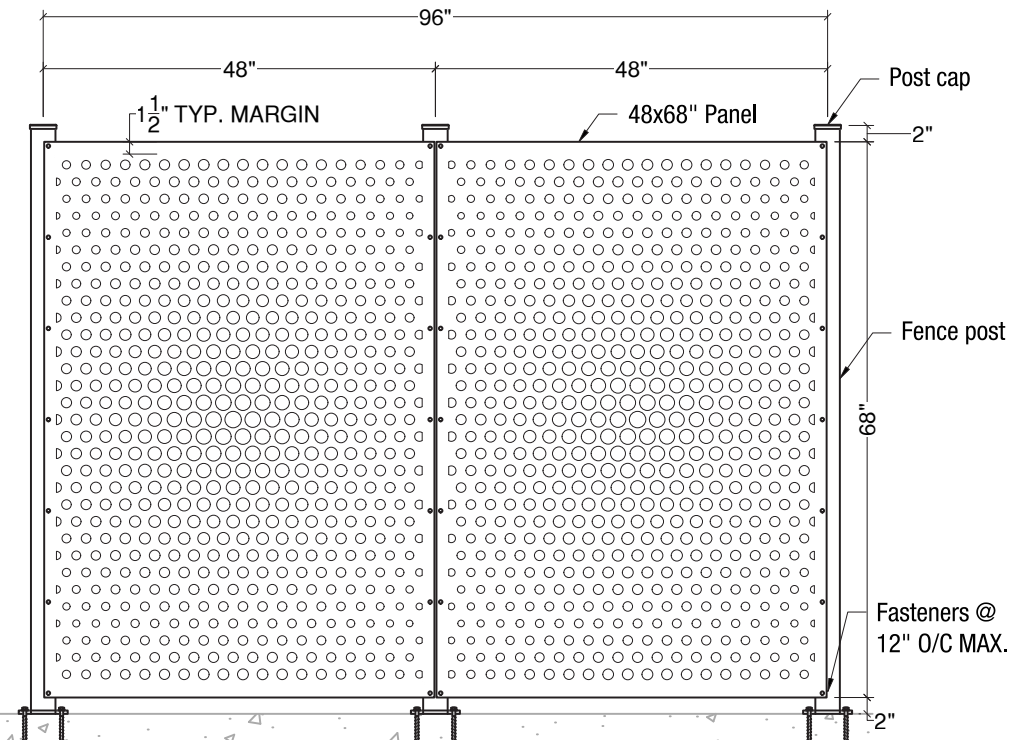

6ft Fence

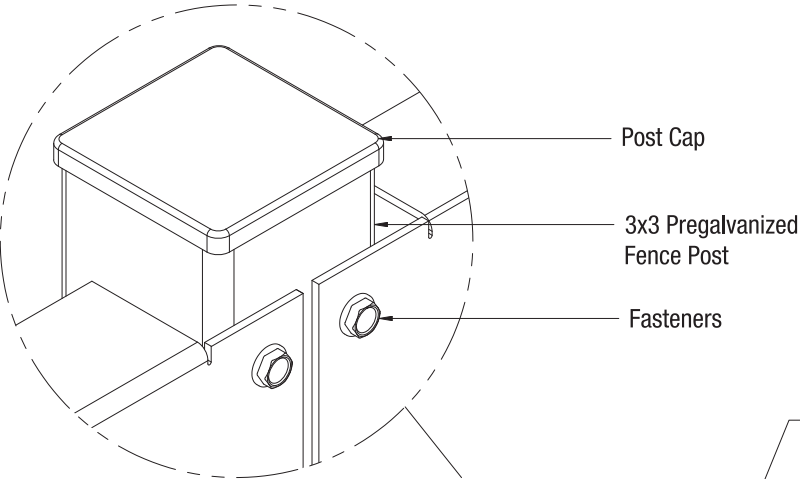

Visit VIVARAILINGS.COM for range of design patterns or provide your custom one.

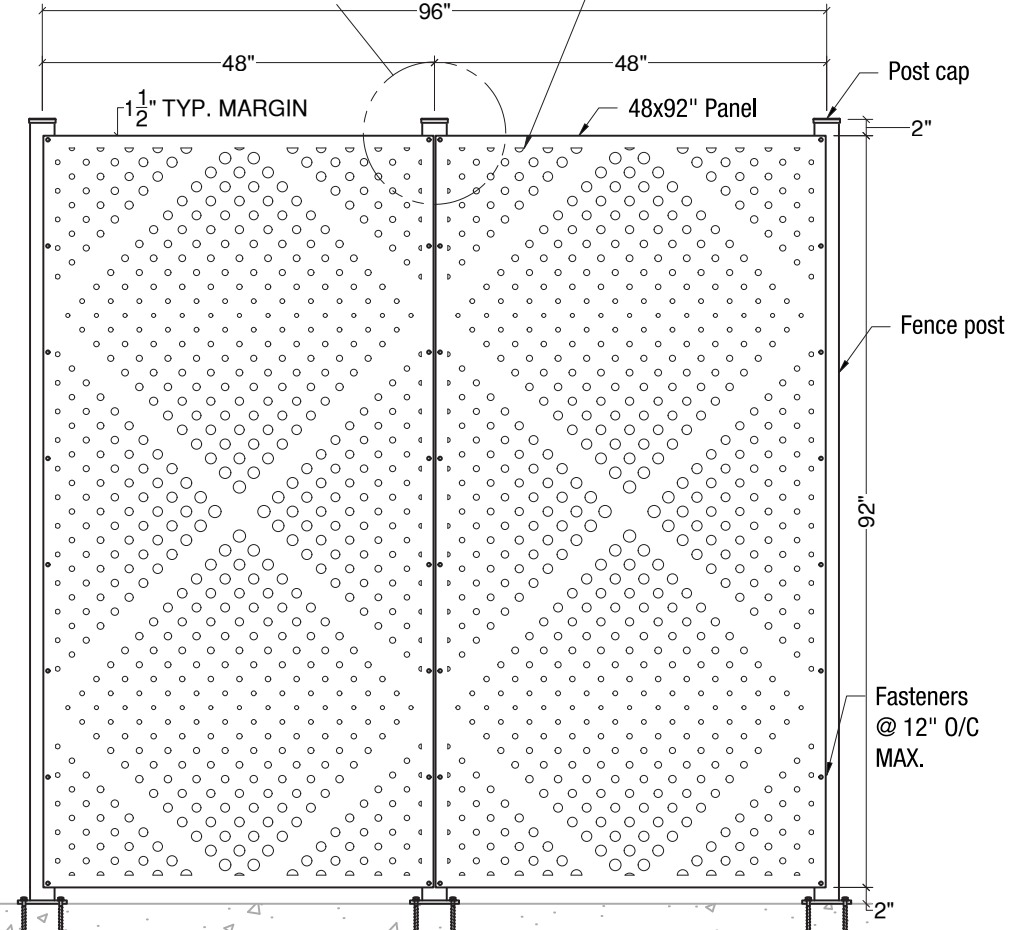

8ft Fence



Mounting Condition

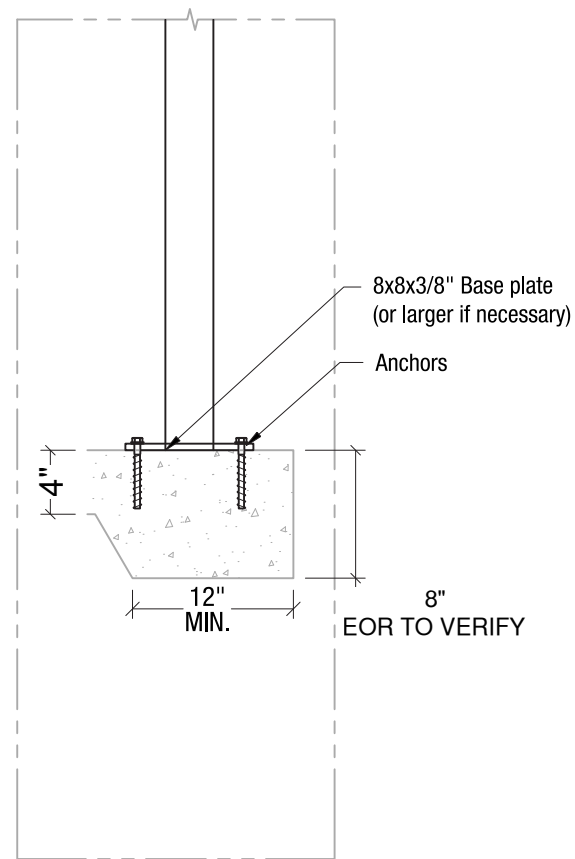

Anchored to Concrete¹ Slab - \$²
Detail# LS-T01

1

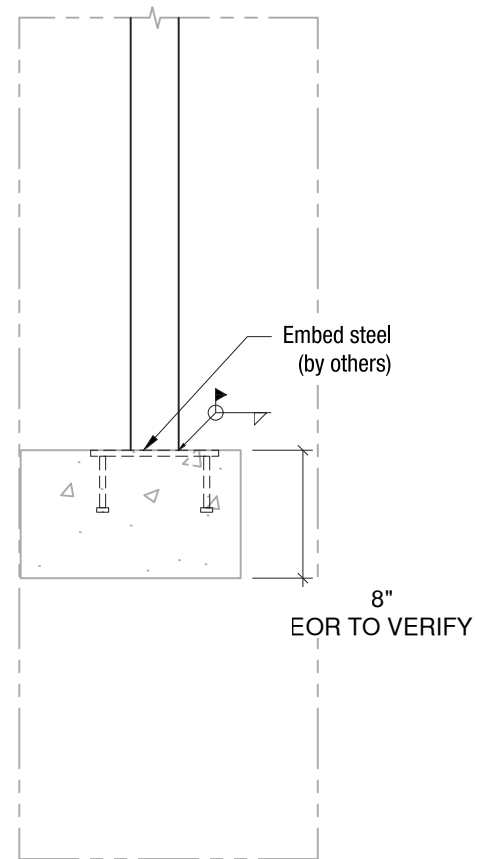

Welded to Embed on Slab - \$
Detail# LS-T02

2

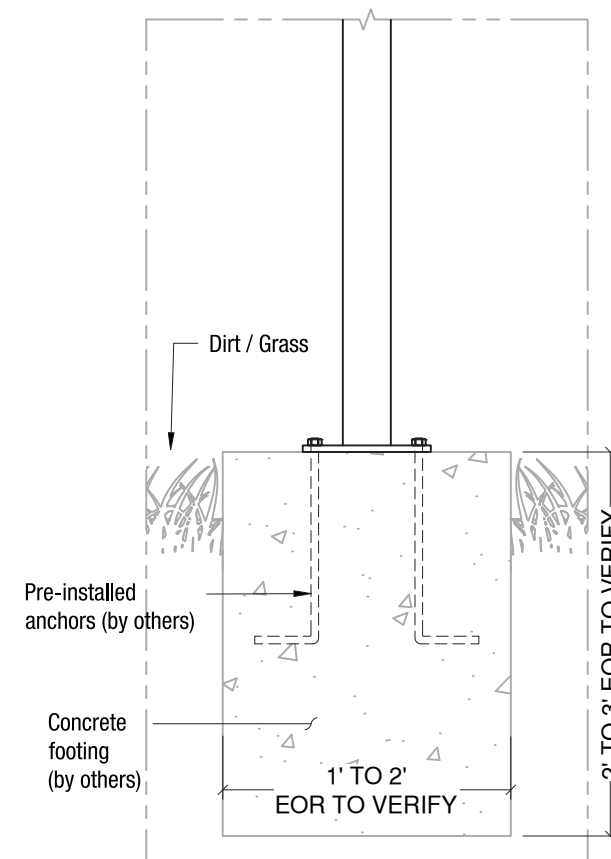

Anchored to Concrete Footing on Dirt - \$
Detail# LS-T03

3

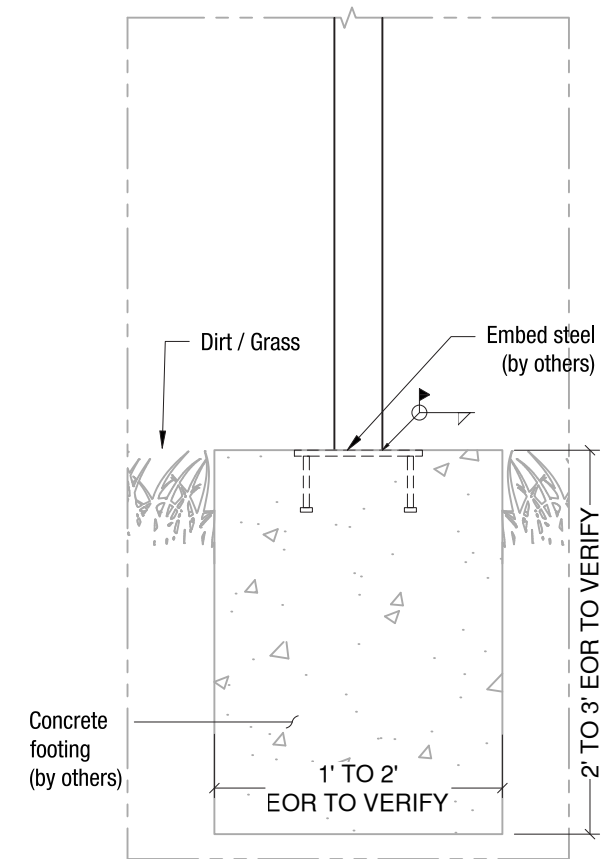

Welded to Embed Footing on Dirt - \$
Detail# LS-T04

4

(1) Min. 4000 PSI concrete, Typ.
(2) \$ to \$\$\$: Indicates finish type comparative cost.

Pattern Collections

Where Performance Meets Personality

At MetalSpaces, we know that WallScapes are more than functional barriers—they are expressive design elements that shape the identity of a space. Our curated pattern categories are tailored for wall applications requiring both aesthetic strength and technical excellence:

Primary

Crisp, modern, and minimal — these linear patterns add structure and repetition to building exteriors.

Geometric

Symmetrical, tessellated designs that bring rhythm and movement to facades.

Organic

Soft, flowing forms that evoke nature. A biophilic touch in even the most urban environments.



Primary Patterns

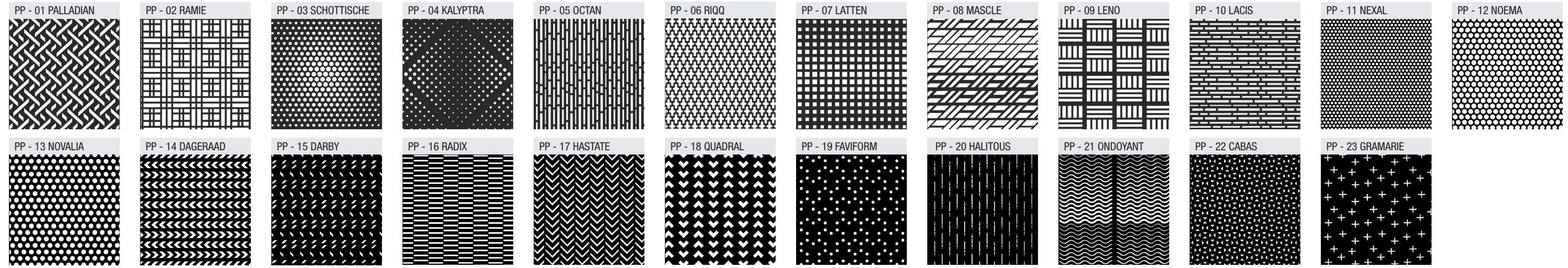

Organic Patterns

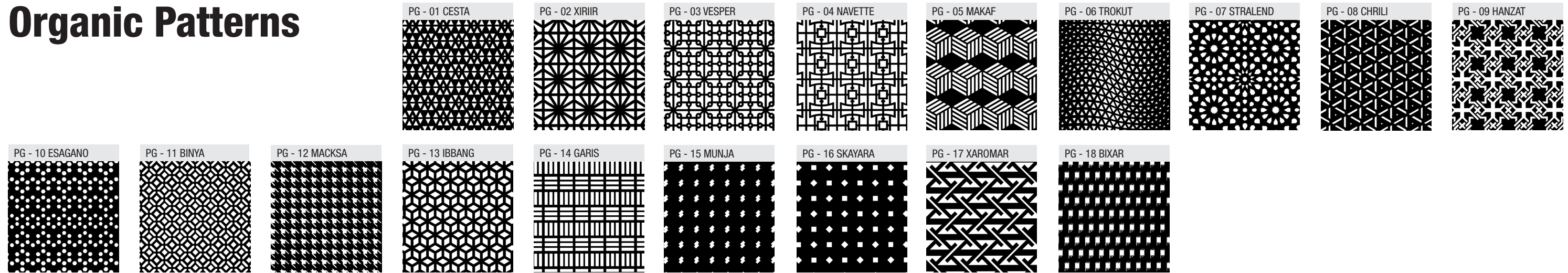

Geometric Patterns

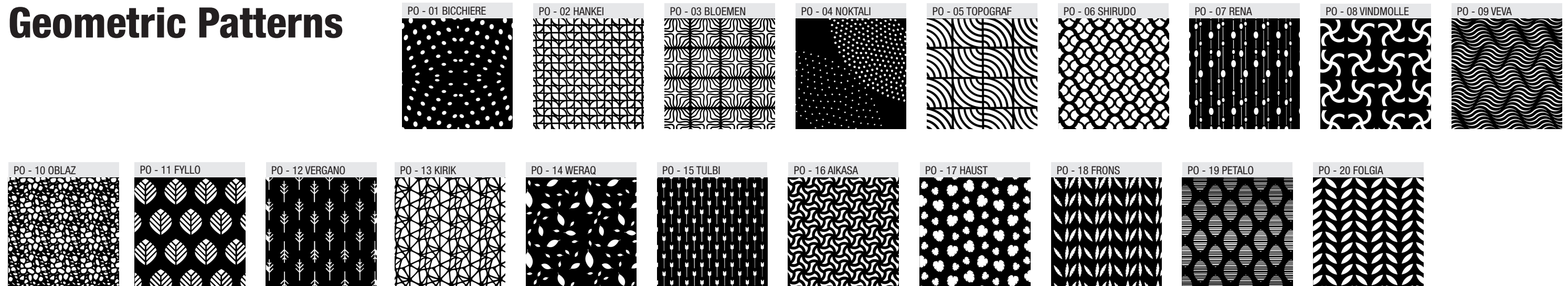



DESIGN + ENGINEER + FABRICATE + INSTALL

151 W. Vista Ridge Mall Dr. Lewisville, TX 75067

(Dallas/Fort Worth Metroplex)

PH: 972.353.8482 | info@vivarailings.com
vivarailings.com



Inc. Magazine 500 | 5000
 VIVA RAILINGS, LLC.
 Among The Fastest Growing
 US Companies
 Eight Years in a Row
2012-2019

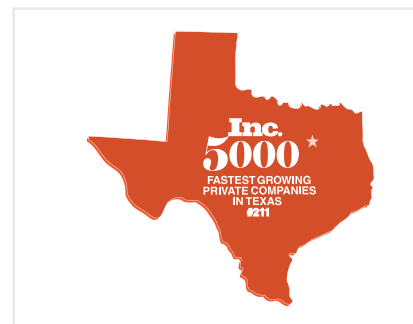

Inc. Magazine 500 | 5000
 VIVA RAILINGS, LLC.
 Among The Fastest Growing
 Texas Companies
#211



ICC-ES 4405 Certified
SHOE™
 Structural Glass Railing System



LEED
 Material & Resources Credits 4.1 and 4.2



The American Institute of Architects



The California Contractors State License
 Board Certified

